

N/F
RACO JACKSON COUNTY, LLC
ZONED: LI

25' UNDISTURBED
GREENWAY/EPD
STREAM BUFFER
(FROM TOP OF BANK)

CL OF CREEK
(TYP.)

TOP OF BANK
(TYP.)

LIFT STATION ESMT

JACKSON-85
DISTRIBUTION
CENTER LIFT
STATION

LIMIT OF
ACCESS FSM
PROP 15' C & G

PROP 50' D.E.

PROP 50' D.E.

100-YR
FLOODING
LIMIT OF C & G

DOG8"

DOG13"

DA

MATCH LINE- SEE SHEET I-1.2 FOR CONTINUATION

AREA A
IRRIGATION PLAN
SCALE: 1"=30'-0"



IRRIGATION PLAN- AREA A
HOMEGOODS DISTRIBUTION CENTER
HOMEGOODS, INC.

REVISIONS		
NO.	DATE	DESCRIPTION
1	8-9-13	Addendum 1
2		
3		
4		
5		
6		

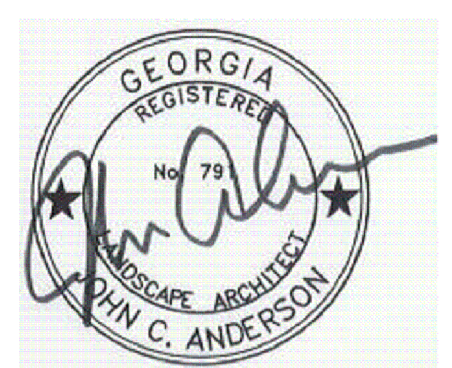

**ANDERSON
DESIGN**
LANDSCAPE ARCHITECTURE
P.O. BOX 491632
LAWRENCEVILLE, GA 30049
T: 770.277.1157
F: 770.995.9023
E: andersondesign@bellsouth.net

THIS DRAWING IS AND SHALL REMAIN THE PROPERTY OF ANDERSON DESIGN, INC. AND SHALL NOT BE REPRODUCED OR COPIED IN ANY FORM WITHOUT WRITTEN CONSENT. IF CONTRACTOR FINDS IN THE COURSE OF THE WORK DISCREPANCY BETWEEN THE PLANS AND THE ACTUAL CONDITIONS OF THE CONSTRUCTION SITE OR ANY ERRORS OR OMISSIONS, IT SHALL BE THE RESPONSIBILITY OF THE CONTRACTOR TO NOTIFY ANDERSON DESIGN, INC. IN WRITING. ANY WORK DONE AFTER DISCOVERY, UNLESS AUTHORIZED, WILL BE AT THE CONTRACTOR'S RISK.

DATE: AUGUST 9, 2013
JOB #: 13-616
FILE: 130806ib
SHEET: 11.1

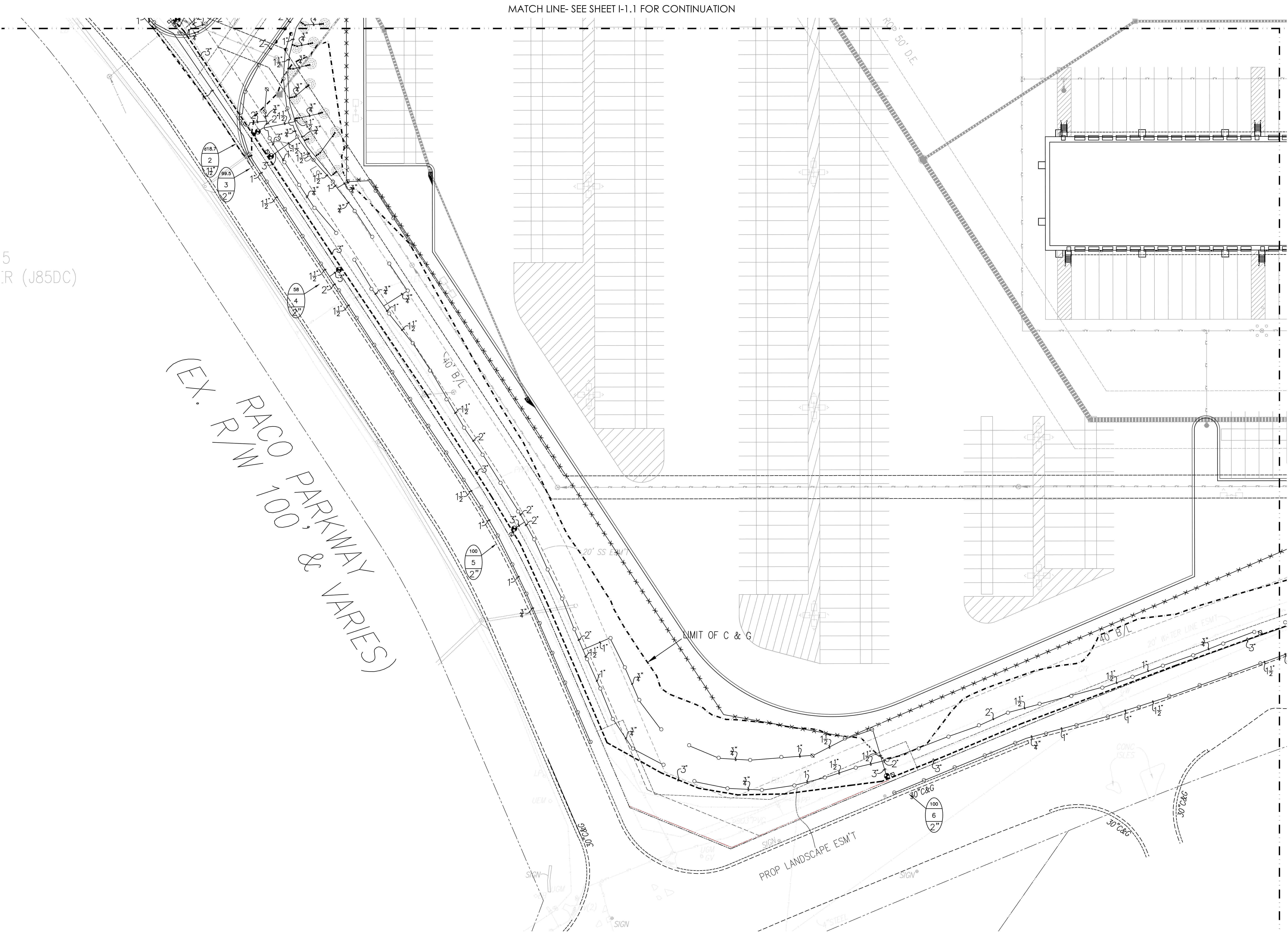

5
R (J85DC)

(EX. RACO PARKWAY VARIES)
RACO PARKWAY 100' & VARIES)

MATCH LINE- SEE SHEET I-1.1 FOR CONTINUATION

MATCH LINE- SEE SHEET I-1.3 FOR CONTINUATION

AREA B
IRRIGATION PLAN
SCALE: 1"=30'-0"

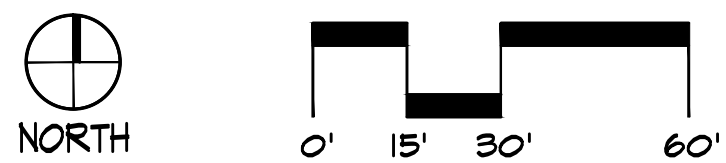

IRRIGATION PLAN- AREA B
HOMEGOODS DISTRIBUTION CENTER
HOMEGOODS, INC.

REVISIONS		
NO.	DATE	DESCRIPTION
1	8-9-13	Addendum 1
2		
3		
4		
5		
6		



**ANDERSON
DESIGN**
LANDSCAPE ARCHITECTURE
P.O. BOX 491632
LAWRENCEVILLE, GA 30049
T: 770.277.1157
F: 770.995.9023
E: andersondesign@bellsouth.net

THIS DRAWING IS AND SHALL REMAIN THE PROPERTY OF ANDERSON DESIGN, INC. AND SHALL NOT BE REPRODUCED OR COPIED IN ANY FORM WITHOUT WRITTEN CONSENT. IF CONTRACTOR FINDS IN THE COURSE OF THE WORK DISCREPANCY BETWEEN THE PLANS AND THE ACTUAL CONDITIONS OF THE CONSTRUCTION SITE OR ANY ERRORS OR OMISSIONS, IT SHALL BE THE RESPONSIBILITY OF THE CONTRACTOR TO NOTIFY ANDERSON DESIGN, INC. IN WRITING. ANY WORK DONE AFTER DISCOVERY, UNLESS AUTHORIZED, WILL BE AT THE CONTRACTOR'S RISK.

DATE:	AUGUST 9, 2013
JOB #:	13-616
FILE:	130806ib
SHEET:	I 1.2

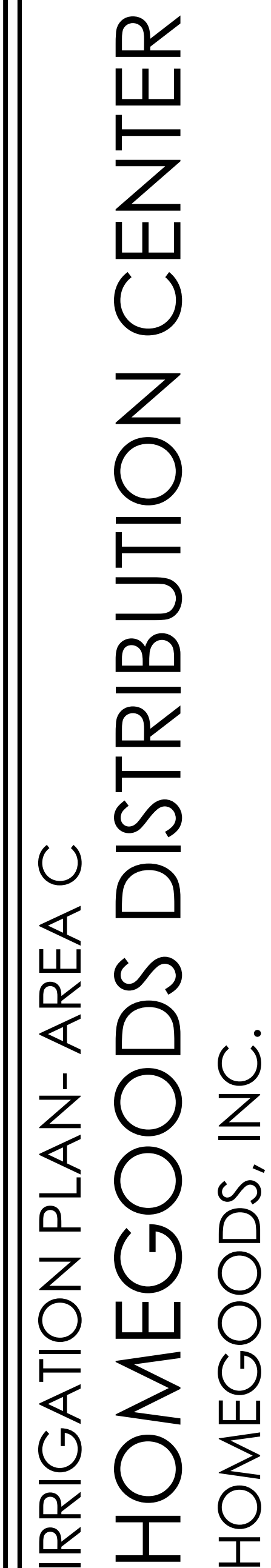

THIS DRAWING IS AND SHALL REMAIN THE PROPERTY OF ANDERSON DESIGN, INC., AND SHALL NOT BE REPRODUCED OR COPIED IN ANY FORM WITHOUT WRITTEN CONSENT. IF CONTRACTOR FINDS IN THE COURSE OF THE WORK DISCREPANCY BETWEEN THE PLANS AND THE ACTUAL CONDITIONS OF THE CONSTRUCTION SITE OR ANY ERRORS OR OMISSIONS, IT SHALL BE THE RESPONSIBILITY OF THE CONTRACTOR TO NOTIFY ANDERSON DESIGN, INC. IN WRITING. ANY WORK DONE AFTER DISCOVERY, UNLESS AUTHORIZED, WILL BE AT THE CONTRACTORS RISK.

DATE: AUGUST 9, 2013
JOB #: 13-616
FILE: 130806ib
SHEET: 113

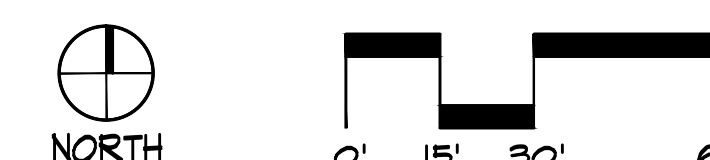

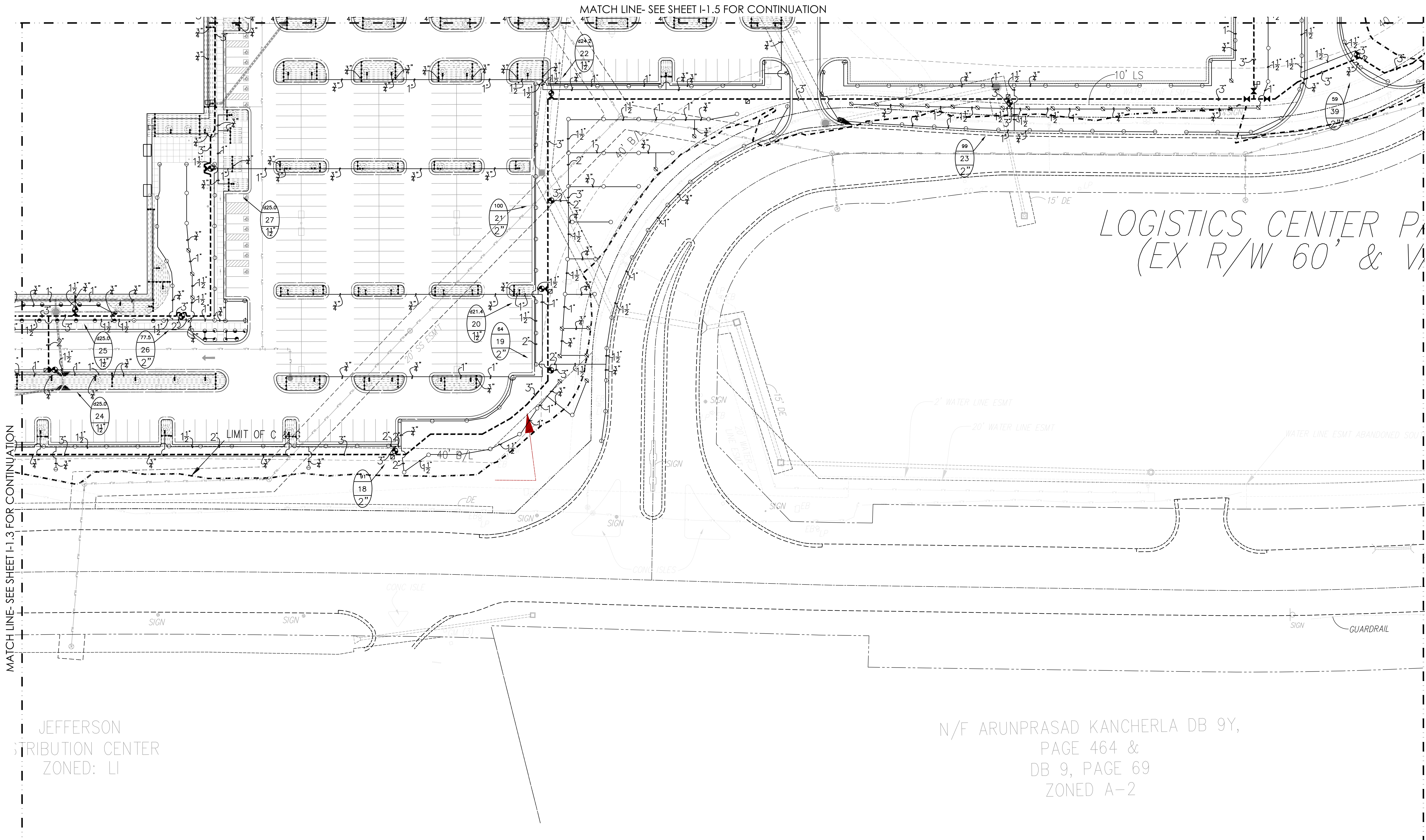

AREA D
IRRIGATION PLAN
SCALE: 1"=30'-0"

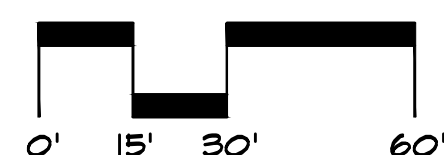

IRRIGATION PLAN- AREA D
HOMEGOODS DISTRIBUTION CENTER
HOMEGOODS, INC.

REVISIONS		
NO.	DATE	DESCRIPTION
1	8-9-13	Addendum 1
2		
3		
4		
5		
6		

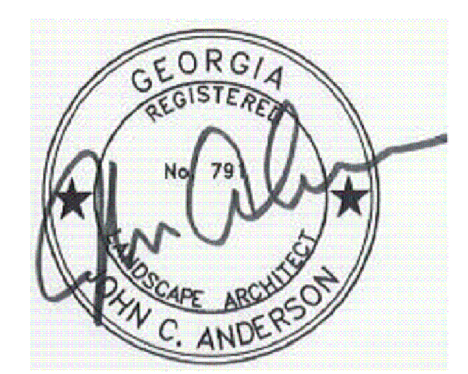

**ANDERSON
DESIGN**
LANDSCAPE ARCHITECTURE
P.O. BOX 491632
LAWRENCEVILLE, GA 30049
T: 770.277.1157
F: 770.995.9023
E: andersondesign@bellsouth.net

THIS DRAWING IS AND SHALL REMAIN THE PROPERTY OF ANDERSON DESIGN, INC. AND SHALL NOT BE REPRODUCED OR COPIED IN ANY FORM WITHOUT WRITTEN CONSENT. IF CONTRACTOR FINDS IN THE COURSE OF THE WORK DISCREPANCY BETWEEN THE PLANS AND THE ACTUAL CONDITIONS OF THE CONSTRUCTION SITE OR ANY ERRORS OR OMISSIONS, IT SHALL BE THE RESPONSIBILITY OF THE CONTRACTOR TO NOTIFY ANDERSON DESIGN, INC. IN WRITING. ANY WORK DONE AFTER DISCOVERY, UNLESS AUTHORIZED, WILL BE AT THE CONTRACTOR'S RISK.

DATE: AUGUST 9, 2013
JOB #: 13-616
FILE: 130806ib
SHEET: 11.4

MATCH LINE- SEE SHEET I-1.7 FOR CONTINUATION

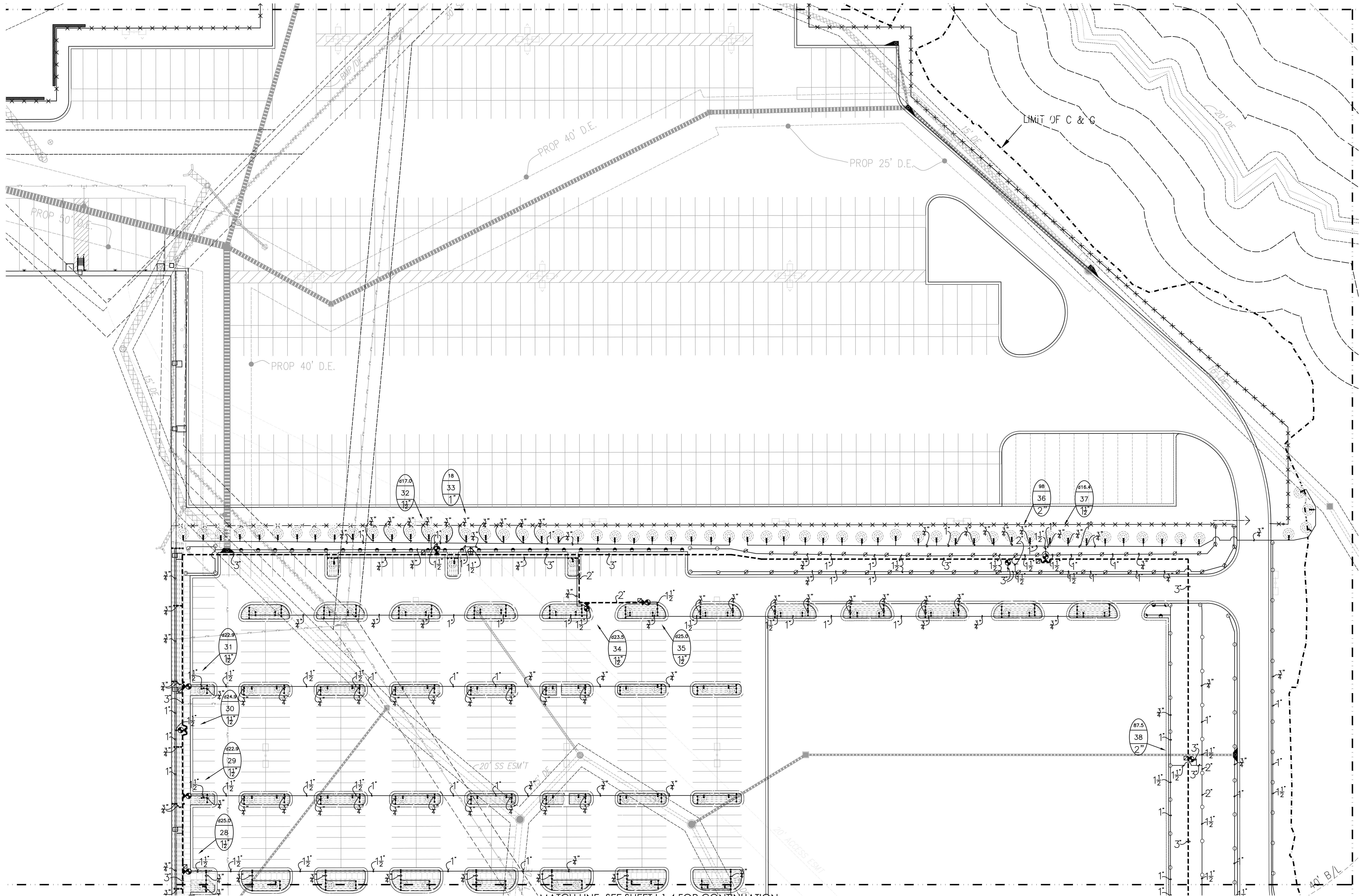

MATCH LINE- SEE SHEET I-1.4 FOR CONTINUATION

MATCH LINE- SEE SHEET I-1.6 FOR CONTINUATION

AREA E
IRRIGATION PLAN
SCALE: 1"=30'-0"

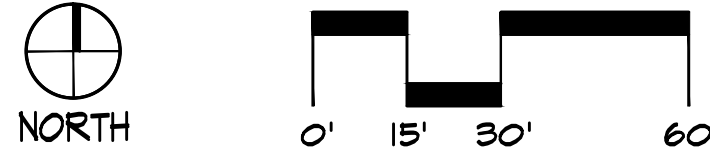

IRRIGATION PLAN- AREA E
HOMEGOODS DISTRIBUTION CENTER
HOMEGOODS, INC.

REVISIONS		
NO.	DATE	DESCRIPTION
1	8-9-13	Addendum 1
2		
3		
4		
5		
6		



**ANDERSON
DESIGN**
LANDSCAPE ARCHITECTURE
P.O. BOX 491632
LAWRENCEVILLE, GA 30049
T: 770.277.1157
F: 770.995.9023
E: andersondesign@bellsouth.net

THIS DRAWING IS AND SHALL REMAIN THE PROPERTY OF ANDERSON DESIGN, INC. AND SHALL NOT BE REPRODUCED OR COPIED IN ANY FORM WITHOUT WRITTEN CONSENT. IF CONTRACTOR FINDS IN THE COURSE OF THE WORK DISCREPANCIES BETWEEN THE PLANS AND THE ACTUAL CONDITIONS OF THE CONSTRUCTION SITE OR ANY ERRORS OR OMISSIONS, IT SHALL BE THE RESPONSIBILITY OF THE CONTRACTOR TO NOTIFY ANDERSON DESIGN, INC. IN WRITING. ANY WORK DONE AFTER DISCOVERY, UNLESS AUTHORIZED, WILL BE AT THE CONTRACTOR'S RISK.

DATE: AUGUST 9, 2013
JOB #: 13-616
FILE: 130806ib
SHEET: 11.5

MATCH LINE- SEE SHEET I-1.4 FOR CONTINUATION

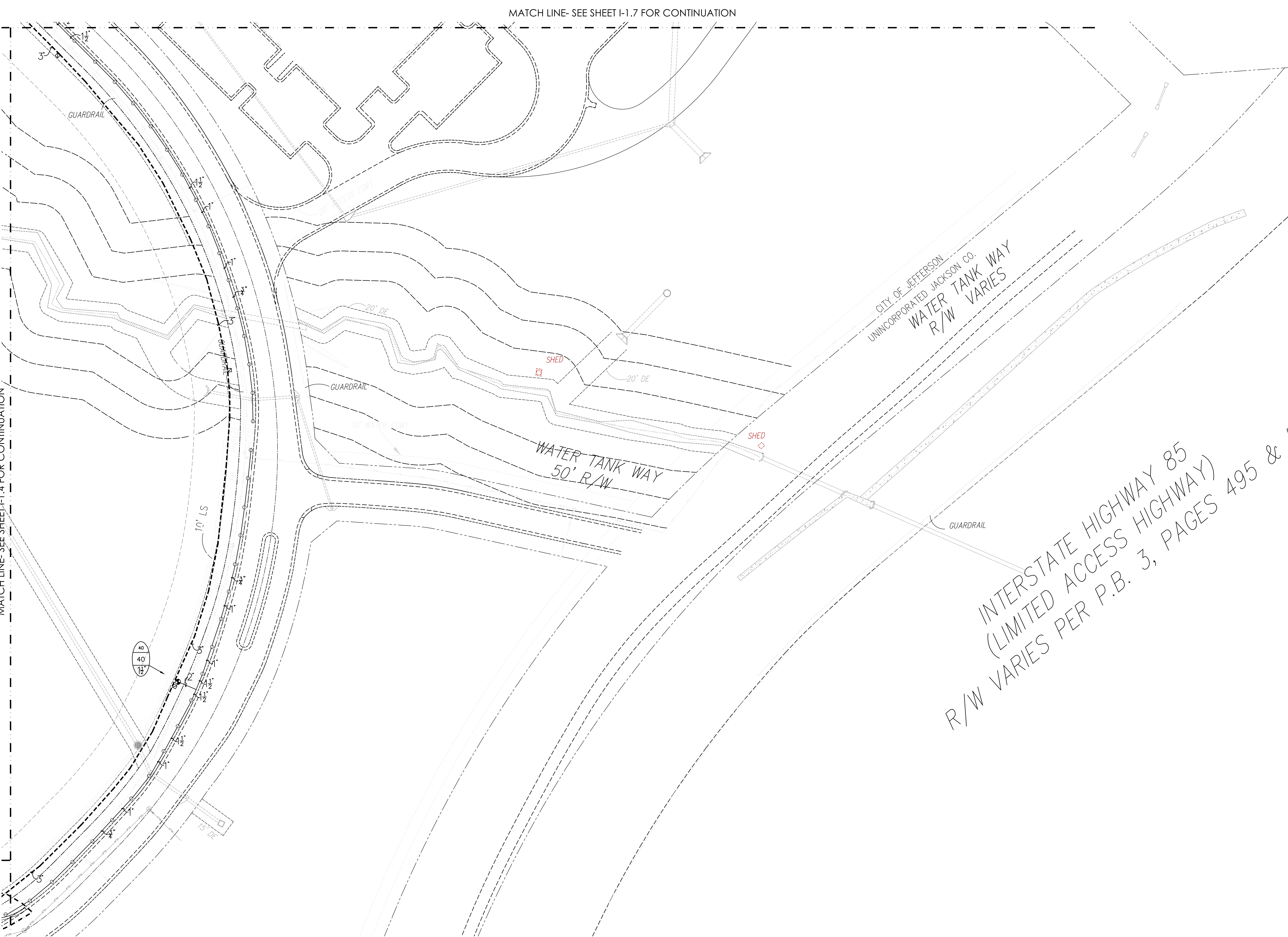

AREA F
IRRIGATION PLAN
SCALE: 1"=30'-0"

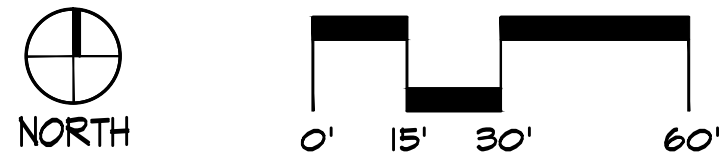

INTERSTATE HIGHWAY 85
(LIMITED ACCESS HIGHWAY)
R/W VARIES PER P.B. 3, PAGES 495 &

CITY OF JEFFERSON
UNINCORPORATED JACKSON CO.
WATER TANK WAY
R/W VARIES

WATER TANK WAY
50' R/W

MATCH LINE- SEE SHEET I-1.7 FOR CONTINUATION

IRRIGATION PLAN- AREA F
HOMEGOODS DISTRIBUTION CENTER
HOMEGOODS, INC.

REVISIONS		
NO.	DATE	DESCRIPTION
1	8-9-13	Addendum 1
2		
3		
4		
5		
6		

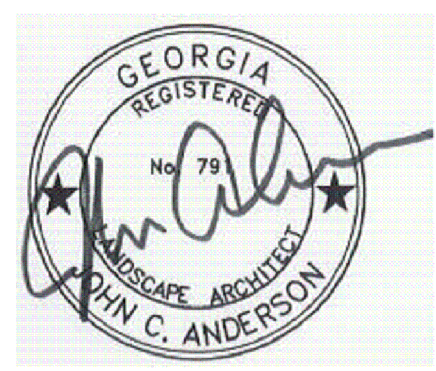

ANDERSON
DESIGN
LANDSCAPE ARCHITECTURE

P.O. BOX 491632
LAWRENCEVILLE, GA 30049
T: 770.277.1157
F: 770.995.9023
E: andersondesign@bellsouth.net

THIS DRAWING IS AND SHALL REMAIN THE PROPERTY OF ANDERSON DESIGN, INC. AND SHALL NOT BE REPRODUCED OR COPIED IN ANY FORM WITHOUT WRITTEN CONSENT. IF CONTRACTOR FINDS IN THE COURSE OF THE WORK DISCREPANCY BETWEEN THE PLANS AND THE ACTUAL CONDITIONS OF THE CONSTRUCTION SITE OR ANY ERRORS OR OMISSIONS, IT SHALL BE THE RESPONSIBILITY OF THE CONTRACTOR TO NOTIFY ANDERSON DESIGN, INC. IN WRITING. ANY WORK DONE AFTER DISCOVERY, UNLESS AUTHORIZED, WILL BE AT THE CONTRACTOR'S RISK.

DATE:	AUGUST 9, 2013
JOB #:	13-616
FILE:	130806ib
SHEET:	11.6

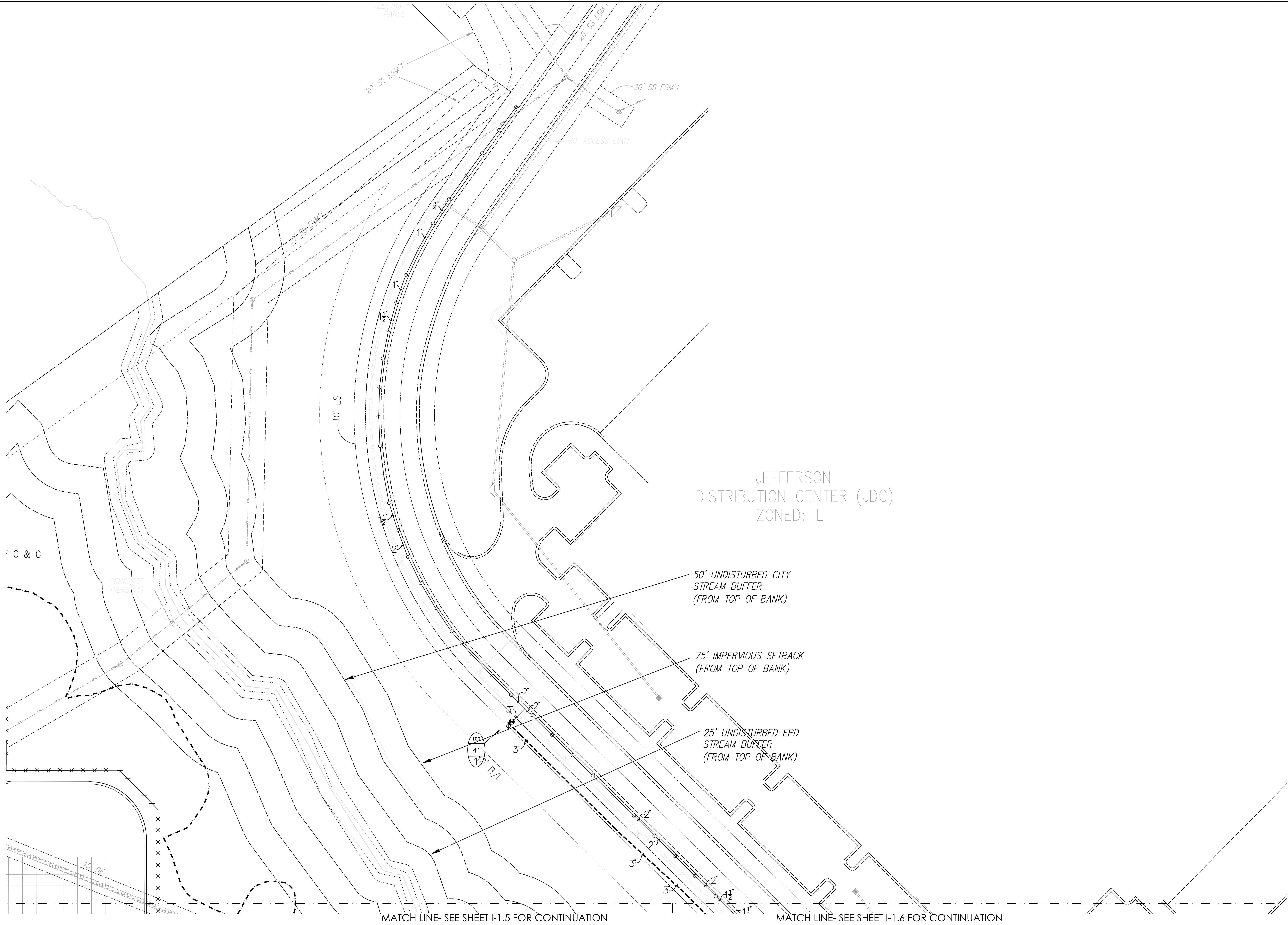

AREA G
IRRIGATION PLAN
SCALE: 1"=30'-0"

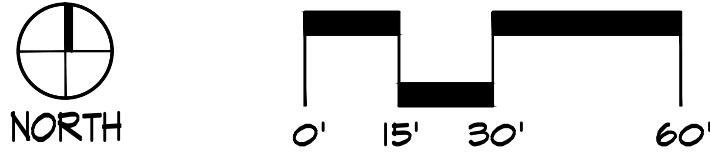

IRRIGATION PLAN- AREA G
HOMEGOODS DISTRIBUTION CENTER
HOMEGOODS, INC.

REVISIONS		
NO.	DATE	DESCRIPTION
1	8-9-13	Addendum 1
2		
3		
4		
5		
6		

Stamp

ANDERSON
DESIGN

LANDSCAPE ARCHITECTURE

P.O. BOX 491632
LAWRENCEVILLE, GA 30049
T: 770.277.1157
F: 770.995.9023
E: andersondesign@bellsouth.net

THIS DRAWING IS AND SHALL REMAIN THE PROPERTY OF ANDERSON DESIGN, INC. AND SHALL NOT BE REPRODUCED OR COPIED IN ANY FORM WITHOUT WRITTEN CONSENT. IF CONTRACTOR FINDS IN THE COURSE OF THE WORK DISCREPANCY BETWEEN THE PLANS AND THE ACTUAL CONDITIONS OF THE CONSTRUCTION SITE OR ANY ERRORS OR OMISSIONS, IT SHALL BE THE RESPONSIBILITY OF THE CONTRACTOR TO NOTIFY ANDERSON DESIGN, INC. IN WRITING. ANY WORK DONE AFTER DISCOVERY, UNLESS AUTHORIZED, WILL BE AT THE CONTRACTOR'S RISK.

DATE:	AUGUST 9, 2013
JOB #:	13-616
FILE:	130806ib
SHEET:	I 1.7

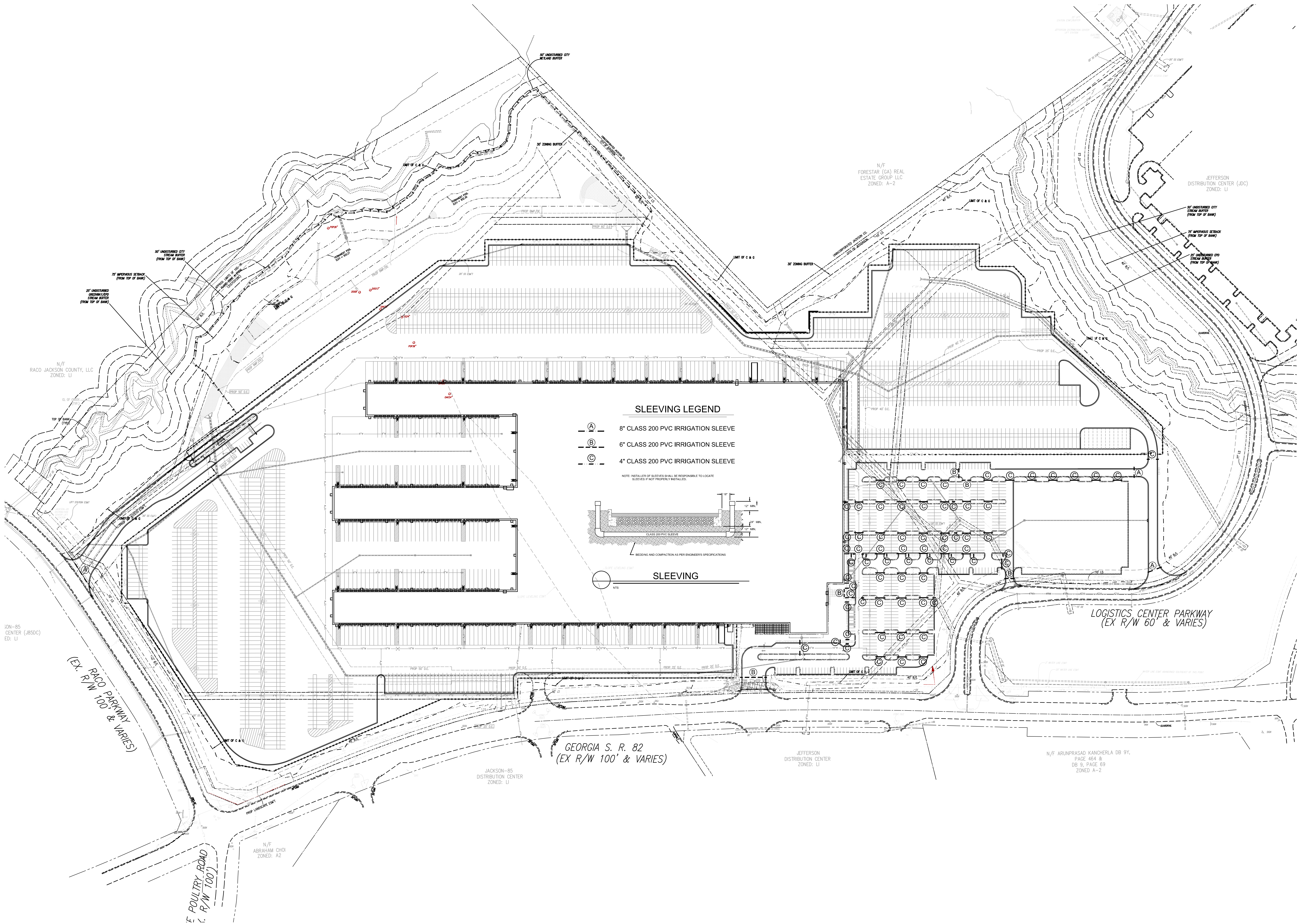

SLEEVING LEGEND

- Ⓐ 8" CLASS 200 PVC IRRIGATION SLEEVE
- Ⓑ 6" CLASS 200 PVC IRRIGATION SLEEVE
- Ⓒ 4" CLASS 200 PVC IRRIGATION SLEEVE

NOTE: INSTALLER OF SLEEVES SHALL BE RESPONSIBLE TO LOCATE SLEEVES IF AUTO PROPERTIES INSTALLED.

CLASS 200 PVC SLEEVE

BEDDING AND COMPACTION AS PER ENGINEER'S SPECIFICATIONS

SLEEVING

IRRIGATION SLEEVING PLAN
HOMEGOODS DISTRIBUTION CENTER
HOMEGOODS, INC.

REVISIONS		
NO.	DATE	DESCRIPTION
1	8-9-13	ADDENDUM 1
2		
3		
4		
5		
6		

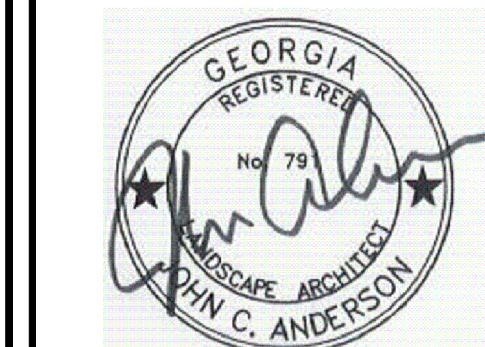

ANDERSON
DESIGN
LANDSCAPE ARCHITECTURE

P.O. BOX 491632
LAWRENCEVILLE, GA 30049
T: 770.277.1157
F: 770.995.9023
E: andersondesign@bellsouth.net

THIS DRAWING IS AND SHALL REMAIN THE PROPERTY OF ANDERSON DESIGN, INC. AND SHALL NOT BE REPRODUCED OR COPIED IN ANY FORM WITHOUT WRITTEN CONSENT. IF CONTRACTOR FINDS IN THE COURSE OF THE WORK DISCREPANCY BETWEEN THE PLANS AND THE ACTUAL CONDITIONS OF THE CONSTRUCTION SITE OR ANY ERRORS OR OMISSIONS, IT SHALL BE THE RESPONSIBILITY OF THE CONTRACTOR TO NOTIFY ANDERSON DESIGN, INC. IN WRITING. ANY WORK DONE AFTER DISCOVERY, UNLESS AUTHORIZED, WILL BE AT THE CONTRACTOR'S RISK.

DATE:	AUGUST 9, 2013
JOB #:	13-616
FILE:	130806ib
SHEET:	11.8

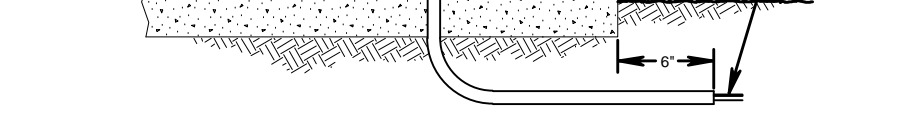
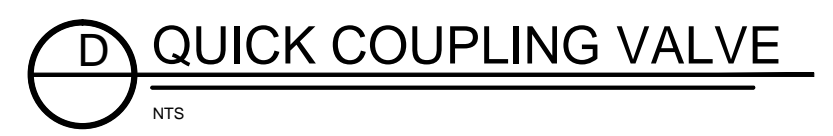

VALVE SIZE



4. ALL MAINLINES TO HAVE A MINIMUM OF 18" OF COVER. (CLASS 200 PVC PIPE).
 5. ALL LATERAL AND SUB-MAIN PIPE TO HAVE A MINIMUM OF 12" OF COVER. (CLASS 200 PVC PIPE).
 6. NO JOCKS, BOUNCERS OR OTHER EXTRANEOUS MATERIALS TO BE USED IN BACKFILLING OF TRENCH.
 7. ALL PIPE TO BE INSTALLED AS PER MANUFACTURERS' SPECIFICATIONS.
 8. ALL THREADED JOINTS TO BE COATED WITH TEFLON TAPE OR LIQUID TEFLO.
 9. ALL LINES TO BE THOROUGHLY FLUSHED BEFORE INSTALLATION OF SPRINKLER HEADS.
 10. SPRINKLER AND RELATED EQUIPMENT TO BE INSTALLED AS PER DETAILS.
 11. ALL ELECTRICAL JOINTS TO BE MADE USING WATERPROOF CONNECTIONS AS SHOWN ON DETAILS.
 12. EQUIPMENT NOT SPECIFIED IN THE LEGEND SHALL BE DETERMINED AND SPECIFIED BY THE CONTRACTOR.
 13. NO ELECTRICAL CONNECTIONS SHALL BE MADE IN THE FIELD EXCEPT AT A VALVE CONTROL BOX OR ANOTHER VALVE BOX SPECIFICALLY FOR CONNECTIONS.
 14. THERE SHALL BE NO DISCREPANCY BETWEEN THIS SHEET AND OTHERS IN THIS SET MUST BE REFERRED TO THE IRRIGATION CONSULTANT BY THE CONTRACTOR FOR CLARIFICATION BEFORE PRECEEDING WITH THE WORK.
 15. ALL 24 VOLT WIRE SHALL BE #12 UFPLF FOR COMMON WIRE, AND #14 UFPLF FOR CONTROL WIRE. NO DIRECT BURIAL OF COPPER.
 16. CONTRACTOR TO BE RESPONSIBLE FOR PROPER COVERAGE OF AREAS TO BE WATERED. I.E. ADJUST HEADS WITH INSUFFICIENT COVERAGE DUE TO BLOCKAGE BY EXISTING OR PROPOSED SITE FEATURES.
 17. CONTRACTOR TO REMOTE TO LANDSCAPE SPRINKLER, SPRINKLER EQUIPMENT AND ACCESSORY MATERIAL FROM INTERFERING WITH PROPER PLANTING, I.E. VERIFY ROOT BALL SIZE FOR PLANTING.
 18. CONTRACTOR SHALL PROVIDE EXPANSION COILS AT EACH WIRE CONNECTION IN VALVE BOX (WIRE EXPAND 3/4" PIPE 12 TIMES).
 19. CONTRACTOR SHALL PROVIDE PROPER DRAINAGE FOR EACH SPRINKLER.
 20. CONTRACTOR TO UTILIZE APPROPRIATE AUTOMATIC DRAIN DEVICE WHERE LOW HEAD DRAINAGE MAY OCCUR.
 21. ALL JOINTS TO BE MOUNTED ON SWING JOINTS - REFER TO DETAILS.
 22. CONTRACTOR SHALL UTILIZE UL94, TAGS ON ALL REMOTE CONTROL VALVES.
 23. 24 VOLT WIRE SHALL BE COLOR CODED: COMMON-WHITE, CONTROL-RED, 24 HOUR PRESSURE-PALE BLUE, 24 HOUR STATIC PRESSURE-PALE GREEN.
 24. GROUNDING EQUIPMENT FOR POWER SUPPLY AND VALVE OUTPUT WITH (2) 8" COPPER CLAD GROUND RODS.
 25. CONTRACTOR SHALL INSTALL MANUFACTURERS' RECOMMENDATION ON FAULT GROUND AND LIGHTNING PROTECTIVE SYSTEMS.
 26. CONTROLLER GROUNDING MUST BE AS PER ASIC REQUIREMENTS.
 27. ALL MATERIAL TO BE SUPPLIED BY CONTRACTOR TO OWNER:
 - A. TWO WRENCHES FOR DISASSEMBLING AND ADJUSTING EACH TYPE OF SPRINKLER HEADS AND VALVE SUPPLIED.
 - B. TWO KEYS FOR EACH OF THE AUTOMATIC CONTROLLERS.
 - C. TWO QUICK COUPLER KEYS WITH MATCHING HOSE SWIVELS.
 28. SYSTEM IS DIAGRAMATIC TO IMPROVE CLARITY. ALL MAINLINE PIPING ELECTRICAL VALVES AND WIRING ARE TO BE INSTALLED IN LANDSCAPE AREAS AND WITHIN PROPERTY BOUNDARIES. CONTRACTOR SHALL BE RESPONSIBLE FOR THE LANDSCAPE PLAN PRIOR TO THE INSTALLATION OF PIPING TO AVOID CONTACT WITH PLANT MATERIALS EXISTING OR NEW.
 29. CONTRACTOR TO ADD EXTENSION RISER TO POP-UP HEADS WHEN NEEDED FOR PROPER COVERAGE.
 30. CONTRACTOR SHALL INSTALL SPRINKLER EQUIPMENT 12" FROM FOUNDATIONS. ALSO INSTALL SPRINKLERS 4" FROM CURB OR WALKS.
 31. PRIOR TO BID, CONTRACTOR SHALL VERIFY THAT RIGHT-OF-WAY AND BACKFLOW REQUIREMENTS NO LATER THAN FIVE DAYS BEFORE BID SUBMITTALS CONTRACTOR SHALL NOTIFY CONSULTANT OF ANY CHANGES FROM PLANS AND SPECIFICATIONS.
 32. IRRIGATION CONTRACTOR SHALL PROVIDE THE OWNER AND LANDSCAPE ARCHITECT WITH A REPRODUCIBLE GROSS MEASURED AS-BUILT DRAWING OF THE INSTALLED IRRIGATION SYSTEM IN AUTOCAD 2010 FORMAT BEFORE FINAL ACCEPTANCE.
 33. A 1-YEAR WARRANTY PERIOD SHALL BE PROVIDED FOR SYSTEM AFTER SUBSTANTIAL COMPLETION IS ACCEPTED. START UP AND ADJUSTING OF SYSTEM IN SPRING TIME SHALL BE INCLUDED IN WARRANTY.
 34. PRIOR TO BID, CONTRACTOR SHALL VERIFY THAT ALL MATERIALS, INSTALLATION PARAMETERS AND CONDITIONS CONFORM TO ALL CITY, STATE, COUNTY CODES AND ORDINANCES. NO LATER THAN FIVE DAYS BEFORE BID SUBMITTALS CONTRACTOR SHALL NOTIFY IRRIGATION CONSULTANT/DESIGNER OF ANY CHANGES REQUIRED DUE TO CURRENT CODE OR ORDINANCE DISCREPANCIES. IF CONTRACTOR DOES NOT CONFORM TO THIS REQUIREMENT, THE CONTRACTOR SHALL BE RESPONSIBLE FOR ALL NECESSARY INSTALLATION CHANGE AND REDRESS COSTS FOR NON-COMPLIANCE.
 35. UNLESS OTHERWISE NOTED, THE CONTRACTOR MUST COMPLETE 2 PRESSURE TESTS OF THE IRRIGATION SYSTEM MAINLINE (BOTH TO SHOW NO DROP IN PRESSURE DURING DURATION OF TEST).
 - A. 24HOUR PRESSURE TEST AT 1.5 TIMES THE SYSTEM STATIC PRESSURE.
 - B. 24HOUR PRESSURE TEST AT 1.5 TIMES THE SYSTEM STATIC PRESSURE.
 36. IRRIGATION INSTALLATION CONTRACTOR SHALL PROVIDE OWNER WITH A COLOR-CODED ZONE DIAGRAM PLAN, 8-1/2"x11" LAMINATED SHEET(S), TO IDENTIFY CONTROLLER STATION TO THE CONTROL VALVE NUMBER FOR EACH CONTROLLER. TO BE LOCATED IN ADHESIVE POUCH ATTACHED INSIDE OF CONTROLLER(S).

REVISIONS		
NO.	DATE	DESCRIPTION
1	8-9-13	Addendum 1
2		
3		
4		
5		
6		

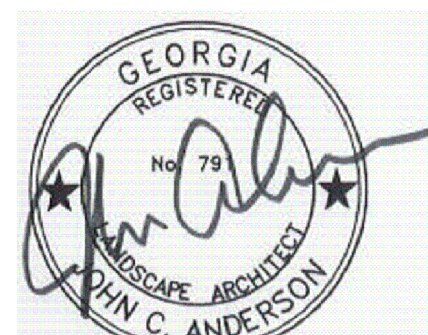

THIS DRAWING IS AND SHALL REMAIN THE PROPERTY OF ANDERSON DESIGN, INC. AND SHALL NOT BE REPRODUCED OR COPIED IN ANY FORM WITHOUT WRITTEN CONSENT. IF CONTRACTOR FINDS IN THE COURSE OF THE WORK DISCREPANCY BETWEEN THE PLANS AND THE ACTUAL CONDITIONS OF THE CONSTRUCTION SITE OR ANY ERRORS OR OMISSIONS, IT SHALL BE THE RESPONSIBILITY OF THE CONTRACTOR TO NOTIFY ANDERSON DESIGN, INC. IN WRITING. ANY WORK DONE AFTER DISCOVERY, UNLESS AUTHORIZED, WILL BE AT THE CONTRACTORS RISK.

SHEET: 11.9